

Gatwick Airport Northern Runway Case Team  
The Planning Inspectorate  
Temple Quay House  
Temple Quay  
Bristol  
BS1 6PN

By email to: [GatwickAirport@planninginspectorate.gov.uk](mailto:GatwickAirport@planninginspectorate.gov.uk)

Date: 5th February 2024

Dear Mr Harold,

**RE: Gatwick Northern Runway Rule 6 letter Reigate & Banstead Borough Council Response**

Thank you for informing Reigate and Banstead Borough Council on the Rule 6 letter associated with the Gatwick Northern Runway Development Consent Order application.

On the draft Examination Timetable, we would suggest that Hearings held during the week commencing Monday 29<sup>th</sup> April should be restricted to the Monday to Wednesday as there are local elections in Reigate & Banstead and elsewhere on Thursday 2 May with counts taking place on Friday 3<sup>rd</sup> May. Other than that, Reigate and Banstead Borough Council (RBBC) has no comments to make on the draft examination timetable and the initial assessment of principal issues is broad enough to cover the range of issues we believe require initial investigation.

Attendance at the Preliminary Meeting and Issue Specific Hearings has been confirmed via the online forms on the PINs website. RBBC officers will attend the Preliminary Meeting and will be available to make contributions to the discussions as required by the ExA. Officers will attend the Open Floor Hearings online to observe but do not wish to participate.

We appreciate the early publication of the agendas for the Issue Specific Hearings and if further detail on areas for discussion were to be made available closer to the meetings that would be welcomed by the local authorities.

We note that a number of significant areas including air quality have not been included in the initial Issue Specific Hearings and we would welcome the opportunity for these issues to be explored by the ExA in future hearings.

As an Affected Party we request that a CAH is held, as allowed for within the draft examination timetable. Areas we would want to raise at this include issues relating to the acquisition of plots of land owned by Reigate and Banstead in Church Meadows and Riverside Gardens, provisions for replacement land (Car Park B), and management and maintenance arrangements.

**Accompanied Site Inspection – suggested locations**

We have reviewed the preliminary site visits undertaken by the Examiners in October 2023. Whilst we recognise that coverage has been extensive, due to the size of the scheme and its wider impacts we are proposing a number of additional sites the examiners may wish to include in future site visits. Elements of these may have already been covered on the earlier visits but these proposed elements may provide additional information for the examiners.

Running from Longbridge Roundabout to the junction with the M23:

1. The blocks of flats on the south side of Woodroyd Avenue behind the Texaco Petrol Station on the A23 Brighton Road and the access road between the domestic garages.



2. Properties backing on to A23 London Road, Gatwick Stream, River Mole and Riverside Gardens, Longbridge Road, Horley



3. The footbridge over the railway line accessed via an alleyway from The Crescent, Horley – this provides excellent views to the south (including Car Park B, A23 London Road Bridge over London Brighton Railway Mainline, the South Terminal Roundabout and the location of the future Horley Strategic Business Park).

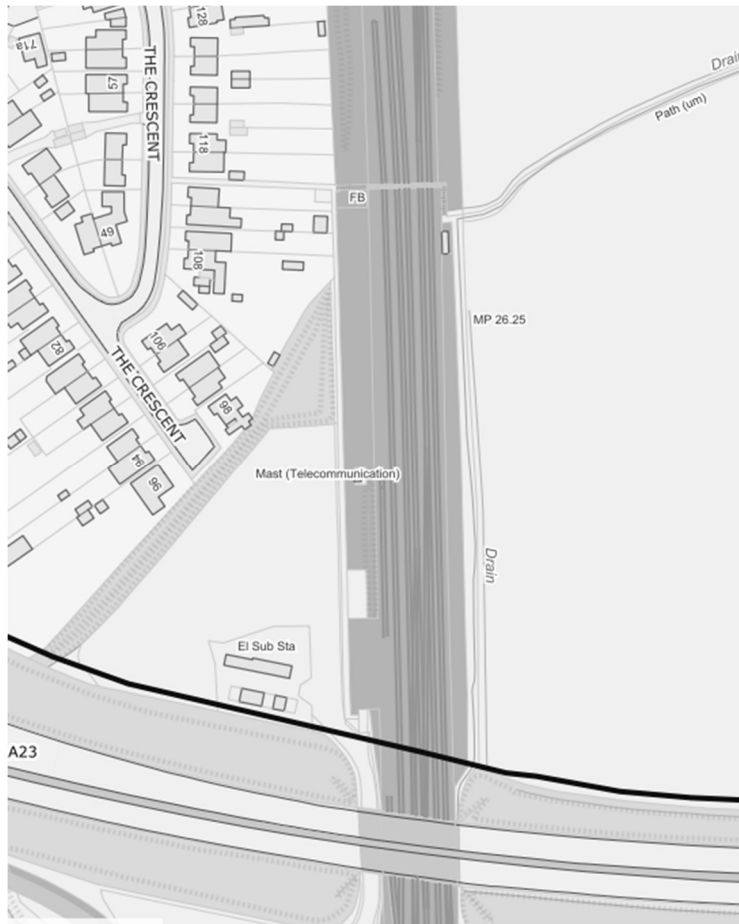

4. The initial part of the footpath on the eastern side of Balcombe Road to the north of M23 Spur Bridge over Balcombe Road which extends towards M23 junction slip road



My colleague, Ian Dunsford, would be happy to accompany any site visit. Please contact [ldf@reigate-banstead.gov.uk](mailto:ldf@reigate-banstead.gov.uk)

Yours sincerely,

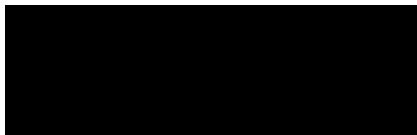

**Andrew Benson**

Head of Planning Services